

# NECROPOLIS

## MEDIUM GENERATOR



### BEFORE YOU BEGIN:

**PLEASE READ THROUGH THE INSTRUCTIONS AND INSPECT THE KIT BEFORE YOU GET STARTED.**

**Tools:** You may need basic hobby tools such as a hobby knife, files, and sandpaper as well as glue to complete the assembly process.

**Glue:** We recommend using both superglue and PVA (white glue). Super glue is necessary for gluing any plastic, acrylic, or resin parts and sets very quickly. PVA gives you more working time if you need it for larger areas or for parts that need extra finesse to get lined up perfectly.

**Cleaning Parts:** The sprue points where parts were attached to the sheets can be sanded flush or carefully saved with a hobby knife. We do not recommend scaping as you would with plastic or resin models as it tends to make the MDF fray and get fuzzy. Part cleaning with a hobby knife is easiest if done before assembly, but can frequently be done after if you have files and sandpaper on hand. Where possible, we try to place sprue points in our designs to be in hidden places to avoid the need for cleaning on many parts.

**Priming:** We highly recommend priming with a FLAT enamel spray paint. Rustoleum and Krylon make these types of paint and are what we use in the studio.

**Painting:** Paint with your normal hobby and spray paints to finish your project.

Thank you so much for your purchase and please reach out if you have any questions or run into any issues.

Email us at: [support@deathraydesigns.com](mailto:support@deathraydesigns.com)  
Chat us on Facebook: [FB.com/DeathRayDesigns](https://www.facebook.com/DeathRayDesigns)



1

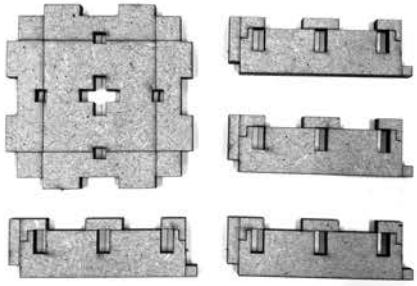

Gather these parts

2



Glue two sides onto the top as shown

3

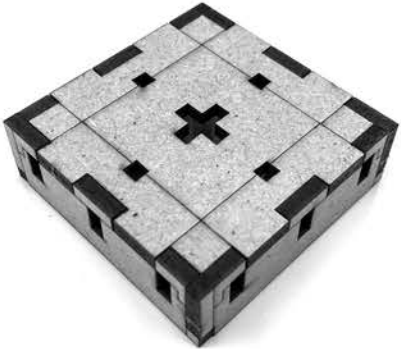

Glue the other two sides on

4



Gather these parts (x6)

5



Glue the longer detail strip onto the middle of each central plate as shown

6



Glue the side plates on both sides with the details facing out



7



Glue the Shorter detail plate on each of the lower pegs as shown

8



Gather these parts

9



Slot the two parts of the central spike together

10



Glue the spike into the box from step 3

11



Set aside the largest ring and glue the remaining 3 rings onto the spike working largest to smallest and place as shown

12



Glue the ring you set aside down around the spike and rings from the previous step and the 4 retaining brackets as shown

13



Glue the remaining 6 pegs into the slots on two opposing sides. You may want to paint before the next step.

14



Glue the ribs finished in step 7 into the remaining 6 slots on the other two sides