

IN-City Industrial Power Station

assembly

Use flat enamel
spray as primer
for best results.

Use superglue or
wood glue for
assembly.

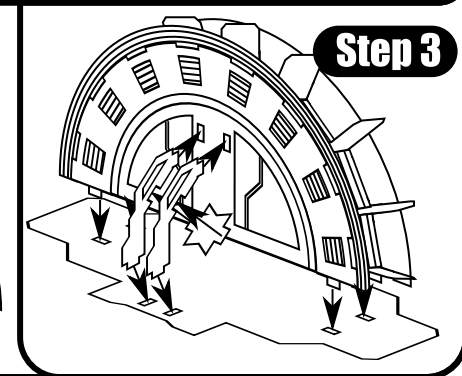
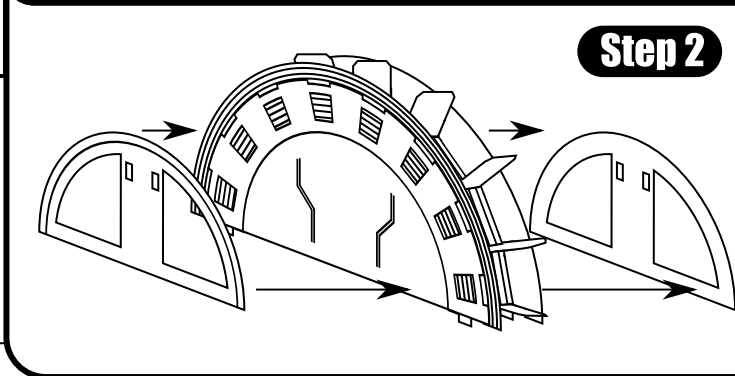
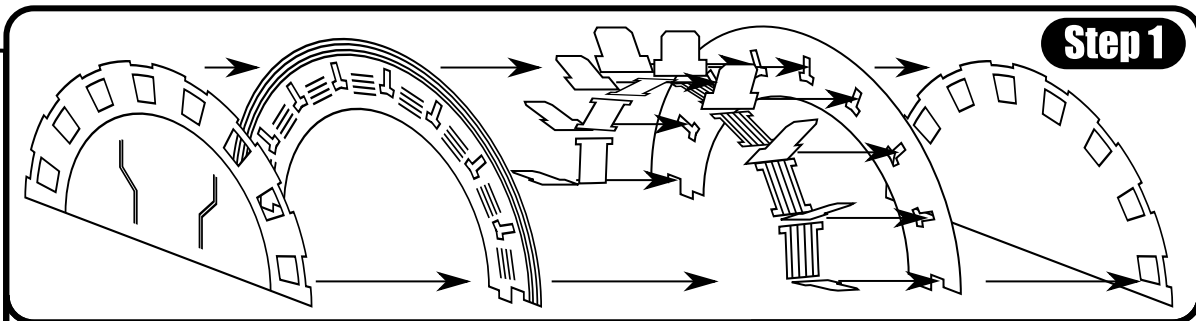

1. Insert striped sheets and tabs into T-shaped slots in the center plate on one side and then place the other plate on the other side.

Place the secondary plates on the outside so that the lines on the center plates show through the holes in the secondary plates.

2. Glue Outer Plates onto the outside.

3. Assemble Struts as in the Step 3 drawing. Insert them into the slots on the outer plates. Then put the base plate on the bottom of the assembly.

Multi-kit Option

Use  instead of 
to link multiple kits together.